

# Instruction manual

## Retro roller model 897

imported by Van der Meulen.

[www.retroroller.eu](http://www.retroroller.eu)

**PLEASE NOTE!** Assembly must be done by an adult. Keep out of reach of young children because of the small parts.

### IMPORTANT:

1. For the child's safety, all assembly steps must be carried out properly. Incorrect assembly could cause injury.
2. Lubricate moving parts regularly or after long-term use.
3. Ensure that all nuts and bolts have been tightened before use. Check nuts and bolts regularly and tighten where necessary.
4. Components showing signs of wear should be replaced immediately.
5. The child should never be left unattended when riding in the vehicle.



# 1

Tools  
Required:

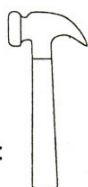

SHORT



OR



# 3

## HARDWARE SET COMPONENTS

PART NO.	Qty	Description	Spec.
*897.8001	9	Hexagon Locknut	M4
*897.8002	1	Machine Screw	M4x24mm
*897.8003	8	Machine Screw	M4x10mm
*897.8004	2	Self Tapping Screw	Ø 4x1/2"
*897.8005	1	Self Tapping Screw	Ø 3.5x8mm
*897.8006	2	Spacer	13mm
*897.8007	4	Hub Cap	Ø 10mm

\*Standard Hardware Items May Be Purchased Locally

# 2

[Part No.] x Qty

Some parts may have already been pre-assembled upon receipt

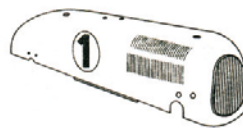

[897.001] x 1



[897.002] x 1



[897.003] x 1



[897.004] x 1

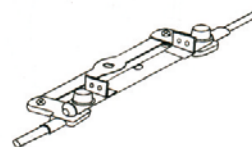

[897.005] x 1



[897.006] x 4

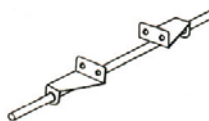

[897.007] x 1



[897.008] x 1



[897.010] x 1



[897.009] x 1



[897.8001] x 9

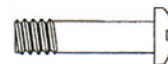

[897.8002] x 1



[897.8003] x 8

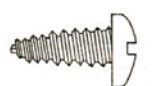

[897.8004] x 2

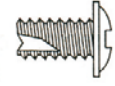

[897.8005] x 1



[897.8006] x 2



[897.8007] x 4



# 4

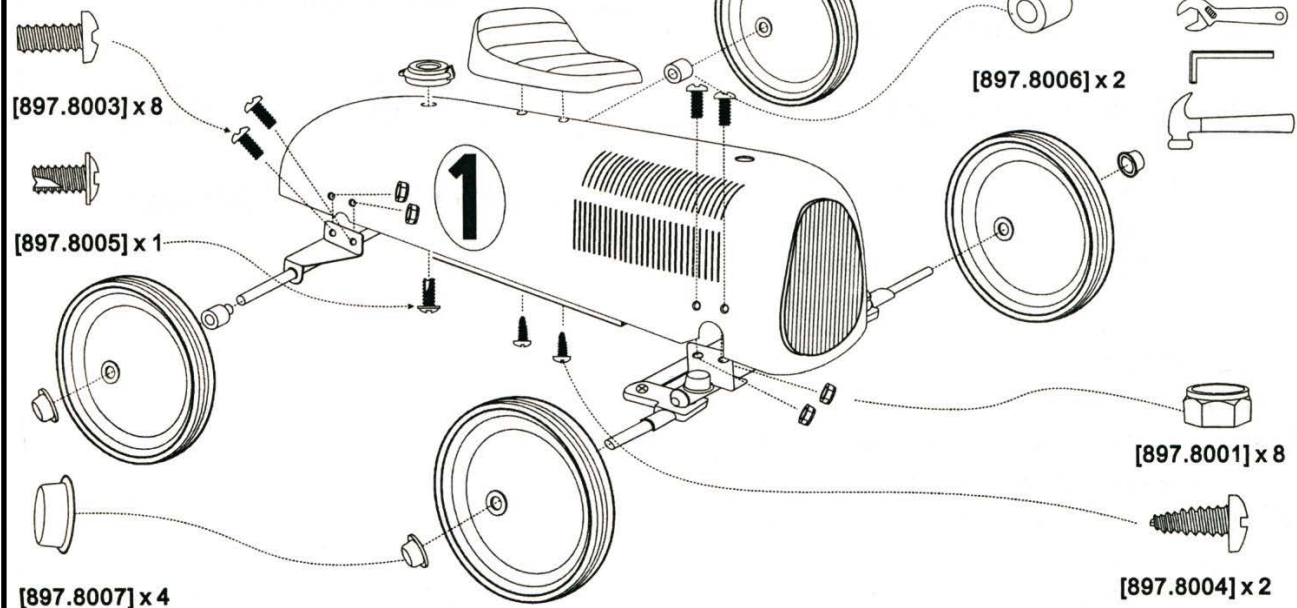

# 5

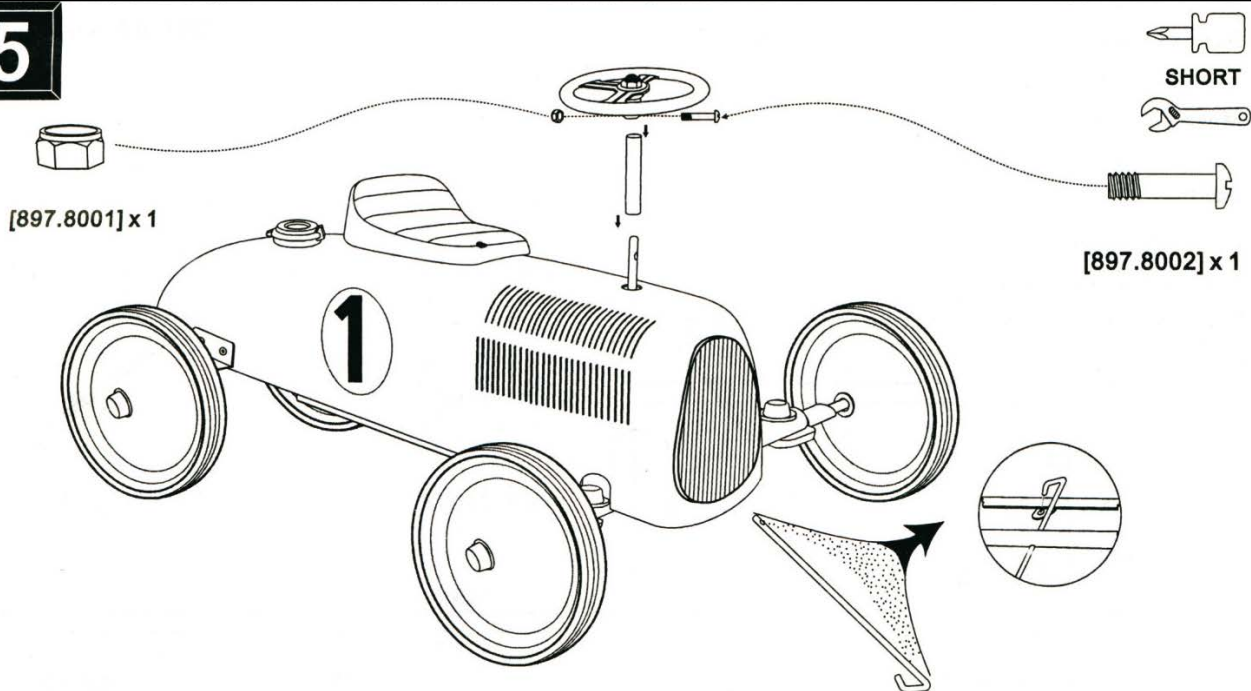

Adult supervision is required! Please make certain that anyone who uses this vehicle has been fully instructed as to the operations of the vehicle.

**WARNING:** This vehicle does not have a braking system. Do not ride on steep hills, staircases or on or near water. Never use vehicle on rough terrain, for jumping or other stunts. No more than one child can be on the vehicle at any time (single passenger only). Shoes and helmet should be worn at all times, to prevent injuries.

Suitable for children over 24 months.

© 2014

